



PULSE**FIRE**®

BACKPACK KIT

USER MANUAL



CAREFULLY READ AND UNDERSTAND ALL INFORMATION CONTAINED WITHIN THIS MANUAL BEFORE OPERATING THIS DEVICE. DO NOT DISCARD. THIS MANUAL SHOULD ALWAYS ACCOMPANY THIS DEVICE AND BE TRANSFERRED WITH IT UPON CHANGE OF OWNERSHIP, OR WHEN LOANED TO ANOTHER PERSON.

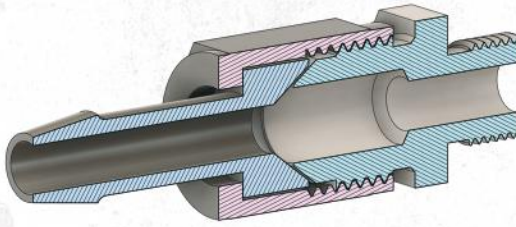

HOSE ADAPTER INCLUDED

If your Pulsefire flamethrower didn't come standard with a 37° flare fitting pre-installed on the rubber hose, we've included one in this kit.

This fitting makes changing between backpack and handheld much simpler. Insert this 2-piece fitting into your plain rubber hose and tighten the clamp. Now you've transformed it into a hose assembly that can quickly thread onto the 37° flare male fitting you installed when setting up your backpack.

Once you install the new fuel pump fitting, you'll never have to remove it again.



READY FOR THE FIELD.

Thank you for purchasing the Pulsefire Backpack Kit, which boosts your capacity to about 3.3 gallons, allowing you over 4 minutes of fuel at your disposal with the standard nozzle.

With this slim backpack reservoir, you'll be able to spend more time sending fire than filling up your fuel tank.

WE'RE HERE FOR YOU.

A company is only as good as its people. We will always do everything in our power to make your experience the best it can be, before and after purchasing. If it's broke, we'll fix it. If you have a question, we'll answer it. If you just want to tell us how much you enjoy your flamethrower, we'll thank you.

Give us a call at **(772) 204-0700** or e-mail us at **info@exothermic.tech** with any questions or concerns and we'll do our best to help!



SAFETY INFORMATION	3
ASSEMBLY AND USE	4
WARRANTY	6
CONTACT US	7



THIS MANUAL CONTAINS IMPORTANT SAFETY WARNINGS AND USAGE INSTRUCTIONS. READ AND UNDERSTAND BEFORE USE. DO NOT DISCARD.

IMPORTANT SAFETY AND USAGE INFORMATION

FILLING/REFUELING

DO NOT open cap unless backpack is on ground or grounded surface. **ALWAYS** pour fuel with fuel supply nozzle making direct contact with reservoir or funnel. Adhering to these guidelines will help prevent static buildup risks.

BEFORE USE

ALWAYS inspect reservoir, hose, and hose connections for fuel leaks. **DO NOT** use if you detect or suspect any fuel leaks. Contact Exothermic Technologies for instructions if a fault is found.



Be safe and enjoy.
Contact us if you have any questions or concerns regarding safety or operation.

STORAGE

Unit should be stored with reservoir no more than 3/4 full to allow for expansion. Disconnect battery and store separately in a fireproof area away from water/heat/sparks or other physical hazards. Battery should be stored with its charge around 11.1-11.3 volts for maximum longevity.

GENERAL

Keep out of reach of children. **DO NOT** expose to or use in temperatures greater than 140°F or lower than 0°F. **DO NOT** drop or impact. **DO NOT** transport while filled with fuel, as fuel may leak from nozzle, especially under pressure from varying environmental conditions (elevation/temperature changes). If temperature or elevation changes significantly, open and close the cap briefly to vent any excess pressure in or out. **DO NOT** use if there is any malfunction whatsoever. Contact us and we will take care of it.

THIS IS A SUPPLEMENTARY USER MANUAL.
READ AND FOLLOW THE INSTRUCTIONS PROVIDED IN THE PULSEFIRE LRT USER MANUAL BEFORE USE.

ASSEMBLY AND USE

- 1 Once your standard fuel tank is empty, use a 13 mm wrench to remove the two screws holding the fuel tank to the body (Figure 1).

If your Pulsefire has a 37° flare fitting preinstalled, use a wrench (16 mm) to hold the fuel pump fitting while using another wrench (19 mm) to unscrew the hose assembly from the fitting (Figure 5). **Skip to step 4.**

- 2 Loosen the clamp securing the hose to the fuel pump fitting and pull the hose off (Figure 2).

- 3 Use a 16 mm wrench to unscrew and remove the hose barb fitting from the fuel pump (Figure 3). Remove the copper washer from the fitting for re-use.

Take the included 37° flare fitting fitting and place the copper washer over the threads. Install the fitting into the fuel pump and be sure to keep the sealing washer as centered as possible, or leaks may occur. Tighten to 80 in-lb (Figure 4). **Do not over-tighten.**

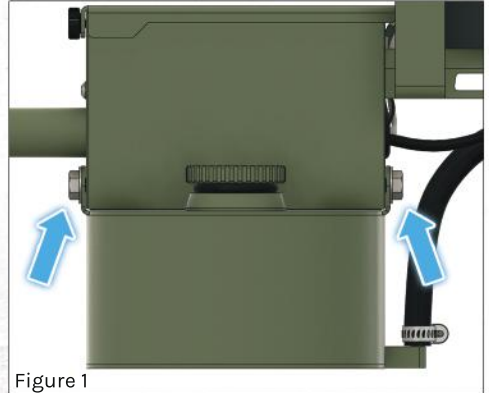

Figure 1

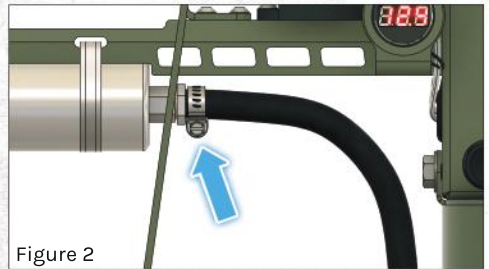

Figure 2

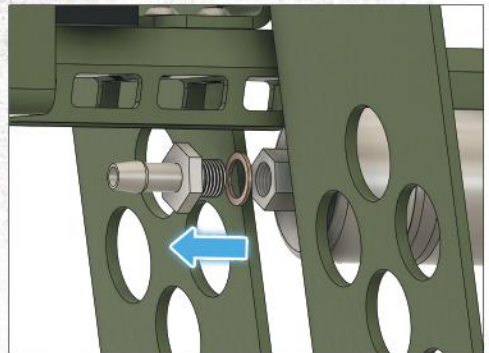

Figure 3

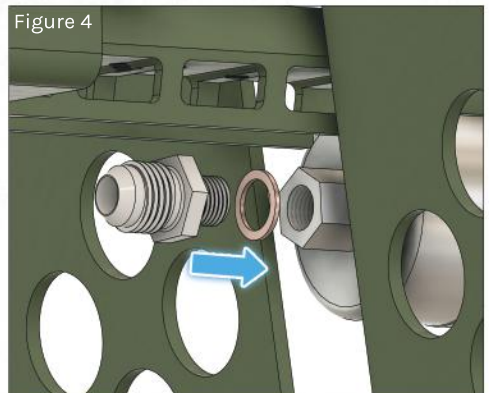

Figure 4

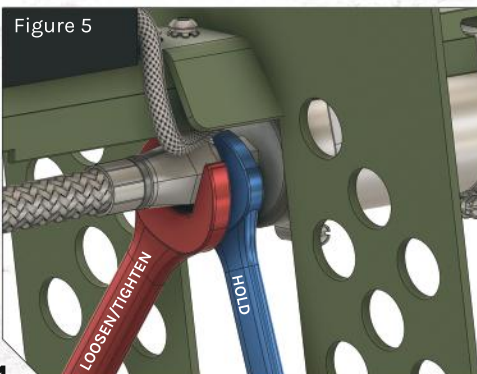

Figure 5

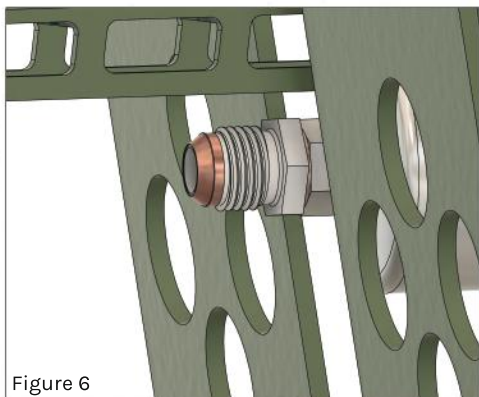

Figure 6

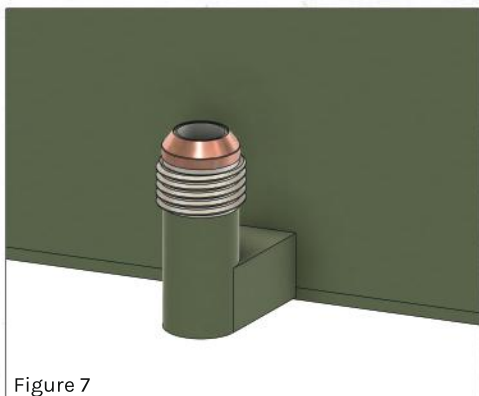

Figure 7

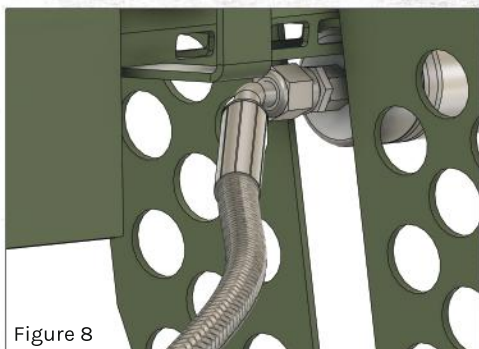

Figure 8

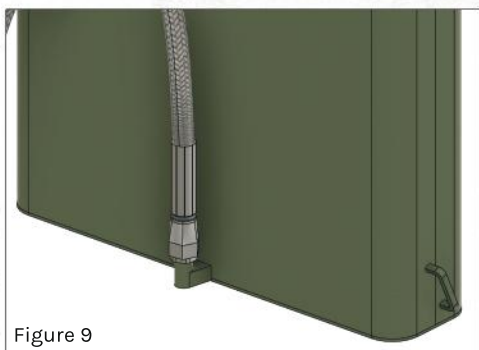

Figure 9



COPPER SEALS ARE VERY FRAGILE AND EASY TO BEND OR DAMAGE. BE EXTREMELY GENTLE.

4

Install a copper flare seal on both male fittings by carefully placing it over the flare on the fuel pump fitting (Figure 6) and the backpack fitting (Figure 7). Ensure they remain straight and in-place during the next step.

5

Take the included braided hose assembly and thread the 45 degree hose end onto the fuel pump fitting at an angle that is comfortable for use (Figure 8). Usually this means making the hose pointed out away from your body. If right-handed, make hose route out to the right of the unit. Opposite if left-handed. Once fully threaded and snug, use a wrench to **tighten to 20 ft-lb (240 in-lb)**.

IMPORTANT: Hold the fuel pump fitting with a 16 mm wrench while tightening the hose assembly onto the fitting. This will prevent you from inadvertently turning and over tightening the fitting into the fuel pump (Figure 5). The goal is to tighten the two fittings to each other; we don't want to turn the pump fitting.

Thread on the straight hose end to the backpack fitting fully by hand and as straight as possible (Figure 9).

Use a wrench to **tighten to 15 ft-lb (180 in-lb)**.

6

Fill with fuel, check for leaks, and the system is ready. Adhere to all instructions and warnings contained in the main Pulsefire LRT owner's manual.

LIMITED LIFETIME WARRANTY



Subject to the terms, conditions and limitations outlined below, Exothermic Technologies guarantees its products against defects in materials and workmanship for life.

To make a claim under this warranty, send an e-mail to info@exothermic.tech and include a detailed description of problem. For repairs that are covered by the warranty, Exothermic Technologies will pay the transportation charges to return your product and transport it back.

If a material or workmanship defect is found, and a valid claim is received, Exothermic Technologies will repair the product. In the event of a defect, this is your exclusive remedy. Once Exothermic Technologies validates your claim, we will provide a return label and make it right. In no event will Exothermic Technologies accept any shipment that is sent C.O.D.

LIMITATIONS OF WARRANTY

This warranty is valid only for products purchased and used in the United States. The warranty will be void if damage is caused by misuse, abuse, or normal wear and tear.

There are no warranties which extend beyond the description on the face hereof. The sole and exclusive remedy pursuant to this warranty is the repair of the product, at the sole discretion of Exothermic Technologies. The implied warranties of merchantability and fitness for a particular purpose are expressly disclaimed.

All disclaimers and limitations of liability shall still apply even if the limited remedy of repair and replacement fails of its essential purpose. In states where permitted, Exothermic Technologies assumes no liability for incidental or consequential damage or for incidental expenses. Any action against Exothermic Technologies based on an alleged breach of this warranty must be brought within one (1) year of the claimed breach. Exothermic Technologies's liability for breach of warranty shall be limited to repair of the product, at the sole discretion of Exothermic Technologies.

The purchaser assumes all liability resulting from unsafe handling or any action that constitutes a violation of any applicable laws or regulations. Exothermic Technologies will not be responsible for injuries or damages resulting from careless handling, unauthorized or unsafe modifications, neglect, fire damage, water damage, theft, abuse, ordinary wear and tear, or unreasonable use of the product. Under no circumstances shall Exothermic Technologies be responsible for incidental or consequential damages with respect to economic loss or injury or property damage, whether as a result of breach of express or implied warranty, negligence or otherwise.

WARRANTY DISCLAIMERS

EXCEPT AS EXPRESSLY SET FORTH ABOVE IN THIS LIMITED PRODUCT WARRANTY SECTION, EACH PRODUCT IS PROVIDED SOLELY ON AN "AS IS" BASIS AND EXOTHERMIC TECHNOLOGIES MAKES NO OTHER WARRANTIES OF ANY KIND. TO THE MAXIMUM EXTENT PERMITTED BY APPLICABLE LAW, EXOTHERMIC TECHNOLOGIES SPECIFICALLY DISCLAIMS AND EXCLUDES ANY AND ALL OTHER WARRANTIES, WHETHER EXPRESS, IMPLIED OR STATUTORY, INCLUDING, WITHOUT LIMITATION, ANY IMPLIED WARRANTIES OF NON-INFRINGEMENT, QUIET ENJOYMENT, MERCHANTABILITY OR FITNESS FOR A PARTICULAR PURPOSE. IF SUCH DISCLAIMER OF ANY IMPLIED WARRANTY IS NOT PERMITTED BY LAW, THE DURATION OF ANY SUCH IMPLIED WARRANTY IS LIMITED TO THE DURATION OF THE WARRANTY PERIOD OF THE LIMITED WARRANTY AS SET FORTH ABOVE. SOME JURISDICTIONS DO NOT ALLOW THE EXCLUSION OF IMPLIED WARRANTIES OR LIMITATIONS ON HOW LONG AN IMPLIED WARRANTY MAY LAST, SO SUCH LIMITATIONS OR EXCLUSIONS MAY NOT APPLY TO YOU. IF APPLICABLE LAW SPECIFIES A MINIMUM WARRANTY PERIOD THAT IS LONGER THAN THE WARRANTY PERIOD SET FORTH IN THE LIMITED WARRANTY, THEN THE WARRANTY PERIOD FOR THE PRODUCT IS SUBJECT TO SUCH APPLICABLE LAW SHALL BE CONFORMED TO THE MINIMUM PERIOD SO REQUIRED. THIS WARRANTY GIVES YOU SPECIFIC LEGAL RIGHTS AND YOU MAY ALSO HAVE OTHER RIGHTS WHICH VARY FROM JURISDICTION TO JURISDICTION.

TL;DR If it's broke, and it's our fault, we'll fix it, all costs covered. If it's broke, and it's not our fault, we'll fix it, just cover shipping. If it's a major repair or replacement, we'll charge as little as possible to get you back in action.

CONTACT US



(772) 204-0700



info@exothermic.tech

7356 Commercial Cir Unit D
Fort Pierce, FL 34951

NOT OPEN TO PUBLIC



[@exothermictech](https://www.instagram.com/exothermictech)



Information in this manual may be periodically updated.
Visit <https://exothermic.tech> to download the latest version.
We also have instructional videos available on our website.

Copyright © 2021 Exothermic Technologies, LLC.
<https://exothermic.tech/intellectual-property>
All rights reserved.